

TABULATION			
PARENT PART NO.	ITEM "1"	ITEM "2"	COLOR
105940	187694	187693	RED
178076	188406	188405	YELLOW

REVISION				
REV	ECO	DESCRIPTION	INIT	DATE
D	ECO16152	DIVIDED PIPE INTO TWO PIECE ASSEMBLY	DIH	12/15/17

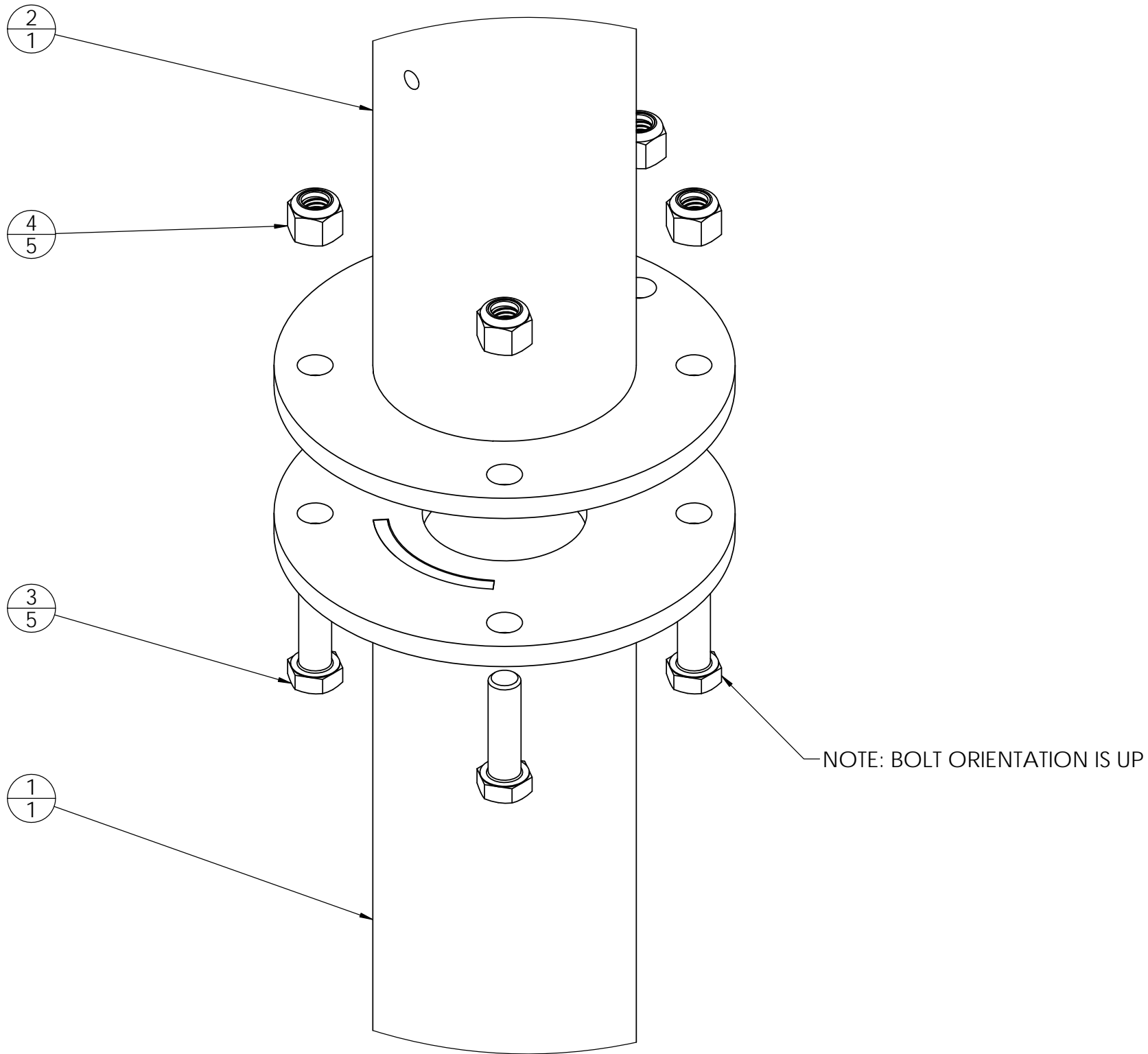
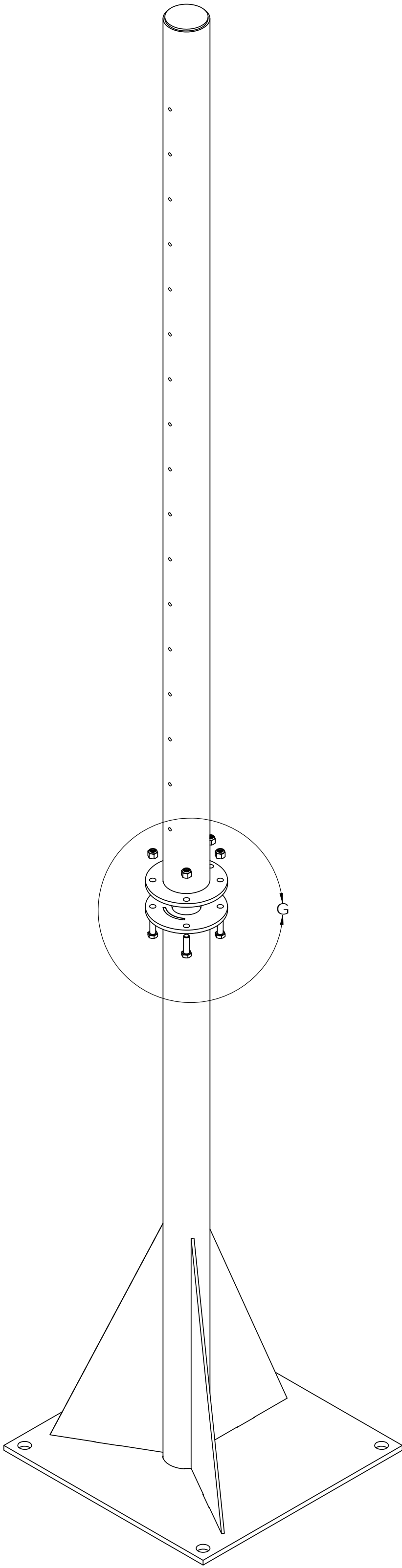
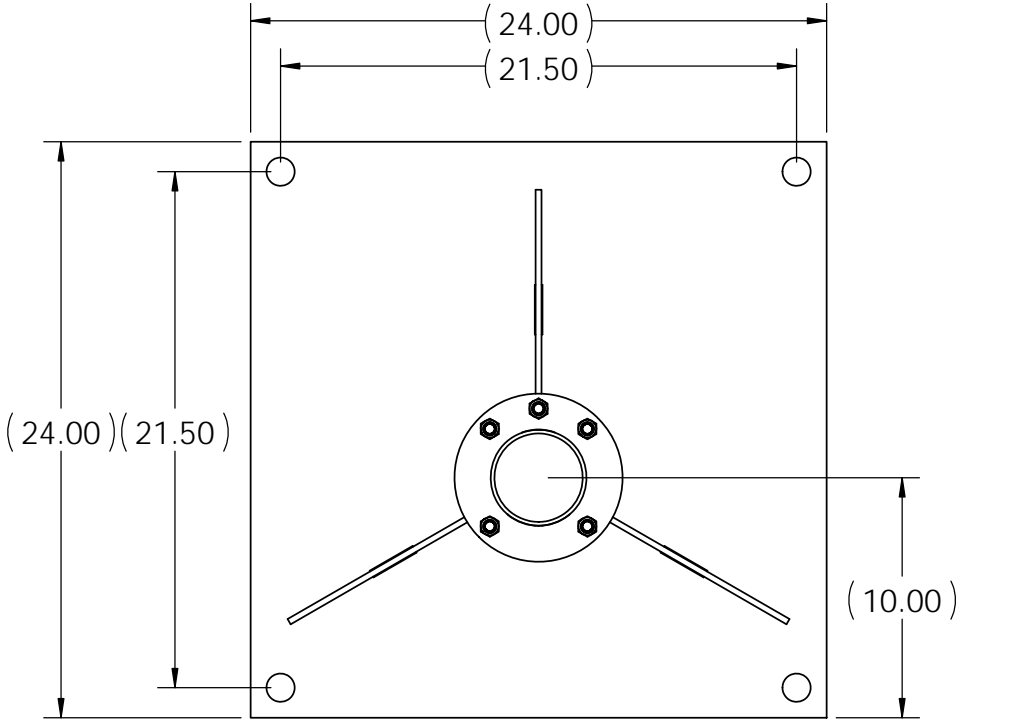

DETAIL G
SCALE 1 : 2

ITEM NO.	PART NUMBER	DESCRIPTION	QTY.
1	SEE TABULATION	Lower Pipe Weldment	1
2	SEE TABULATION	Upper Pipe Weldment	1
3	121483	Bolt, 1/2-13NC x 1-3/4 Hex Head	5
4	14660	NUT, LOCK 1/2-13 HEX NYLON INSERT ZINC PLATED	5
DESIGNED BY: JOMI D.HAFSTAD 12/15/2017		DRAWN BY: JOMI D.HAFSTAD 12/15/2017	REV. APPROVED: JOMI D.HAFSTAD 01/02/2018
TREATMENT NONE		THIS DRAWING AND INFORMATION CONTAINED HEREIN IS AND REMAINS THE PROPERTY OF RICE LAKE WEIGHING SYSTEMS INC. - HEREINAFTER REFERRED TO AS RLWS. IT MAY BE USED ONLY FOR RLWS' PROPOSAL AND/OR ITS CUSTOMERS' ORDERS. IT SHALL NOT BE DISCLOSED OR COPIED WITHOUT RLWS SPECIFIC WRITTEN CONSENT AND SHALL BE IMMEDIATELY RETURNED UPON REQUEST.	UNLESS OTHERWISE SPECIFIED UNITS TO BE INCHES ALL THREADS TO BE CLASS 2 ALL DIMENSIONS APPLICABLE AFTER TREATMENT
NUMBER OF CRANES: MINIMUM CRANE CAPACITY:		TOLERANCES DRAWING TOLERANCES UNLESS OTHERWISE SPECIFIED .XX: ±.01 .XXX: ±.005 ANGLE: ±1°	
ESTIMATED WEIGHT (POUNDS) 218.05		SCALE: 1:8 SHEET: 1 OF 1 DATE: SEE BOM	
THIRD ANGLE PROJECTION		PART NUMBER: 105940 REV: D	