

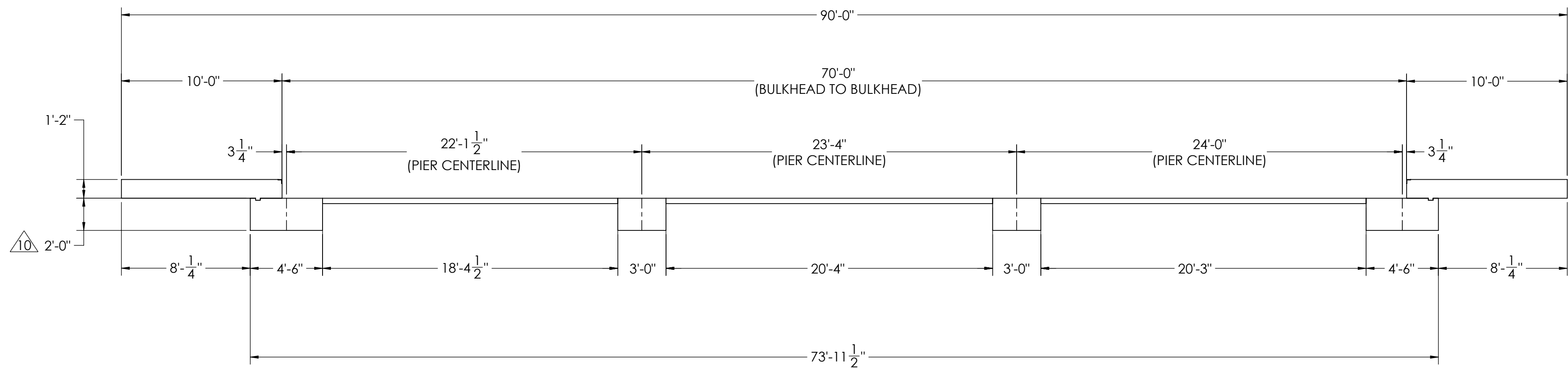

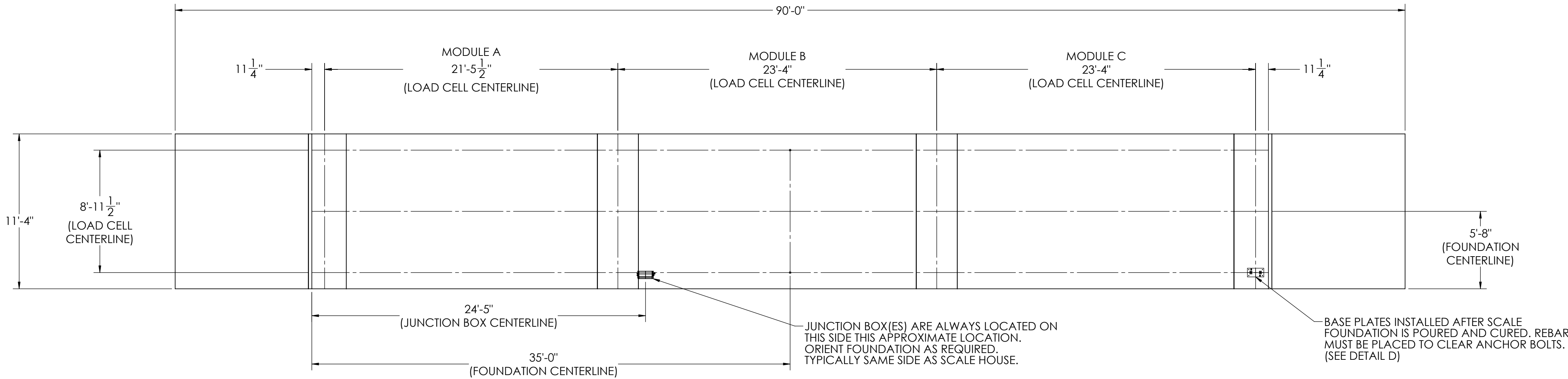

DETAILS

REVISION				
REV.	ECO	DESCRIPTION	INIT	DATE
A	-	ENGINEERING RELEASE	SPJ	12/28/2020



NOTES:

- 1) CONCRETE: F'C = 3000 PSI @ 28 DAYS.
- 2) REINFORCING STEEL: DEFORMED BARS ASTM A615 GRADE 60.
- 3) STATE AND LOCAL AGENCIES MAY HAVE VARIOUS REQUIREMENTS FOR APPROACH RAMP LENGTH, PITCH, AND FOR CLEAN OUT HEIGHT. PLEASE CHECK WITH ALL AGENCIES PRIOR TO CONSTRUCTION.
- 4) MONOLITHIC POUR IS ALLOWED AT CONTRACTOR'S DISCRETION.
- 5) DEVELOP AND MAINTAIN SITE GRADES WHICH WILL RAPIDLY DRAIN SURFACE AND ROOF RUN-OFF AWAY FROM FOUNDATION.
- 6) FOOTINGS HAVE BEEN DESIGNED FOR A MINIMUM SOIL PRESSURE OF 2500 PSF. IT WILL BE THE RESPONSIBILITY OF OTHERS TO VERIFY THIS VALUE.
- 7) WHERE REINFORCING BARS ARE SHOWN CONTINUOUS, LAP SPlice BARS 40 DIAMETERS.
- 8) APPROACHES TO BE A COMMON PLANE WITHIN 1/4".

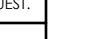
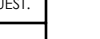
EXPIRATION DATE S. JOHNSON 12/28/2020		DRAWING DATE S. JOHNSON 12/28/2020		REVISION DATE S. JOHNSON 12/28/2020			
TREATMENT NONE		THIS DRAWING AND INFORMATION CONTAINED HEREIN IS AND REMAINS THE PROPERTY OF RICE LAKE WEIGHING SYSTEMS, INC. HEREINAFTER REFERRED TO AS "RICE LAKE". IT IS TO BE USED ONLY FOR THE PROPOSAL AND/OR USE BY ITS CUSTOMER. IF IT IS TO BE USED FOR ANY OTHER PURPOSE, IT SHALL NOT BE REPRODUCED OR COPIED WITHOUT REWRITING SPECIFIC WRITTEN CONSENT AND SHALL BE IMMEDIATELY RETURNED UPON REQUEST.		UNLESS OTHERWISE SPECIFIED UNITS ARE IN INCHES ALL THREADS TO BE CLASS 2 ALL DIMENSIONS APPLICABLE AFTER TREATMENT		RICE LAKE WEIGHING SYSTEMS	
NUMBER OF CIRCLES:		TOLERANCES DRAWING TOLERANCES UNLESS OTHERWISE SPECIFIED $.XX: \pm$ $.XXX: \pm$ \checkmark ANGLE: \pm		DESCRIPTION FOUNDATION, CONCRETE PIER 70' X 11' LOPRO QTR SERIES TRUCK SCALE			
MINIMUM CRANE CAPACITY:				SCALE 1:60		SHEET 1 OF 3	
ESTIMATED WEIGHT (POUNDS):				THIRD ANGLE PROJECTION 		MATERIAL 204214	
		\checkmark				REV A	

CONCRETE SCHEDULE			
		VOLUME (CUBIC YARDS)	
APPROACHES		9.8	
CLEANOUT		8.3	
PIERS		12.6	
TOTAL		38.9	
MISC. STEEL			
PIT COPING	3 X 3 X 1/4	23 LN. FT	113 LBS

VOLUME SHOWN FOR STATED PIER DEPTH.
ADD ADDITIONAL CONCRETE FOR
DEEPER PIERS AS NEEDED.

CONCRETE LAYOUT

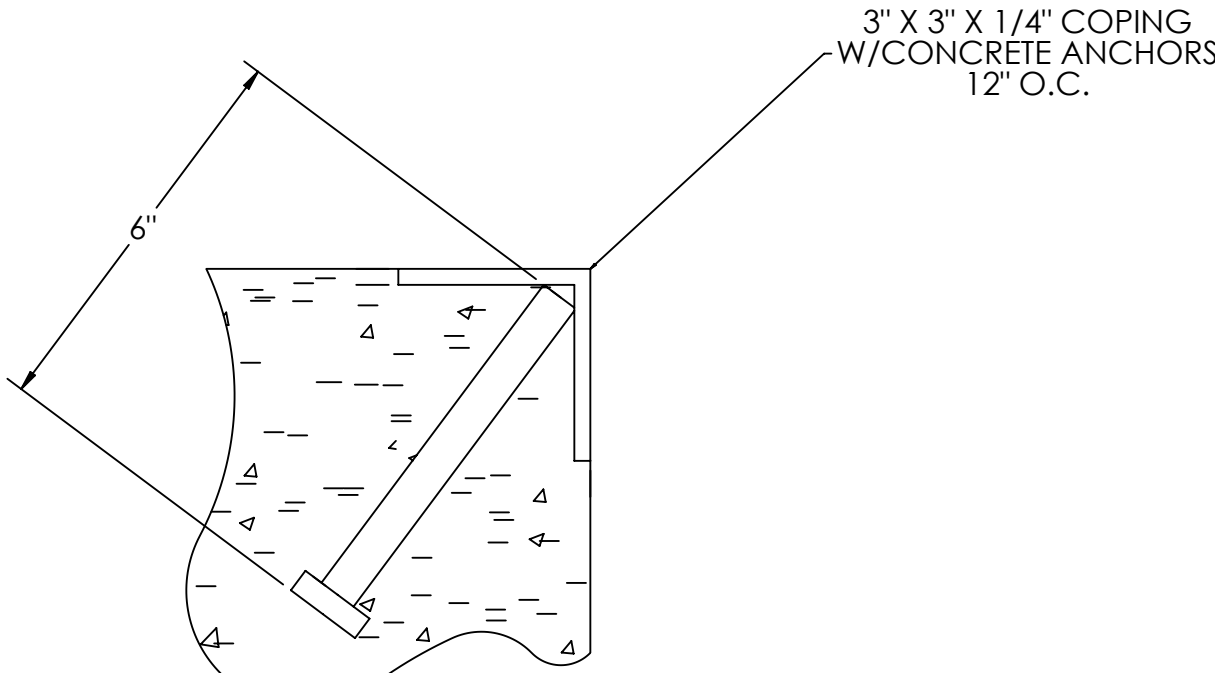

DETAIL C

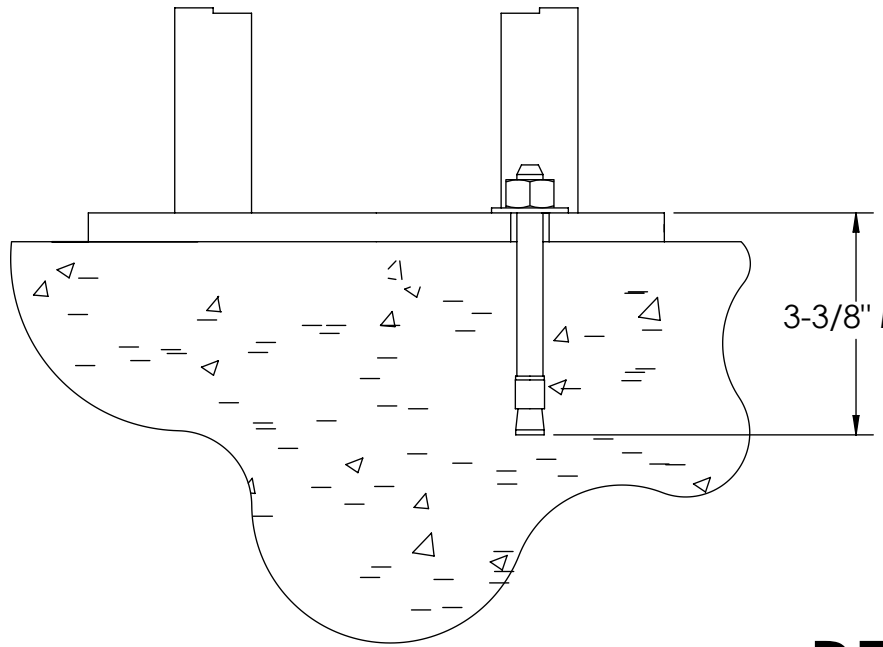

DETAIL D

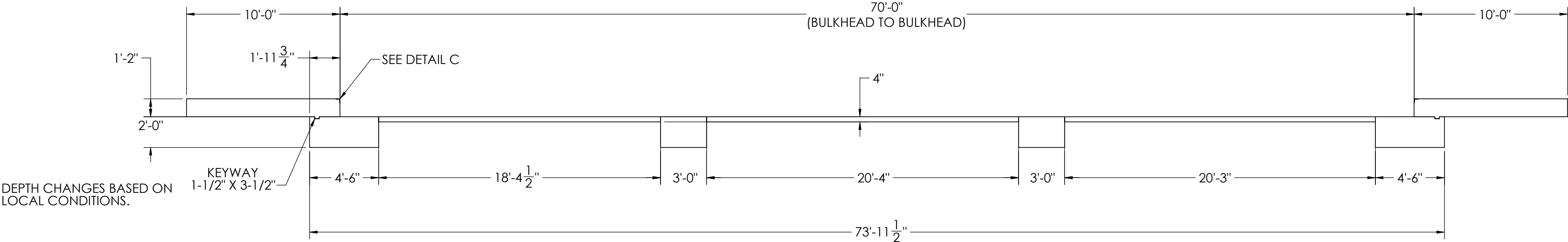
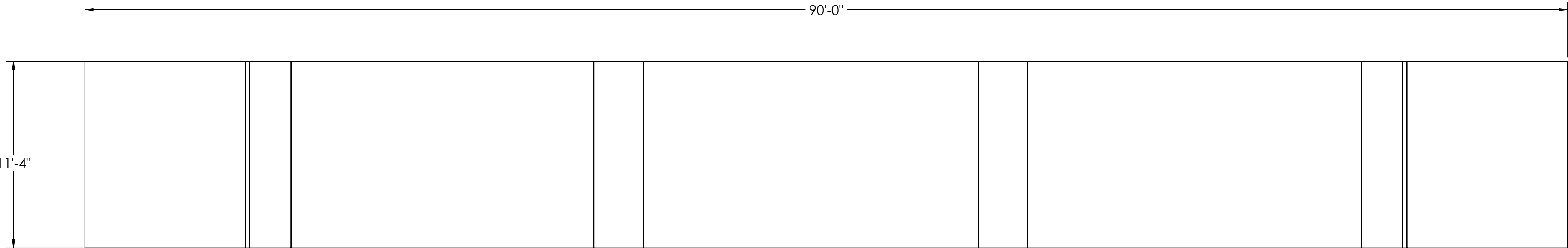
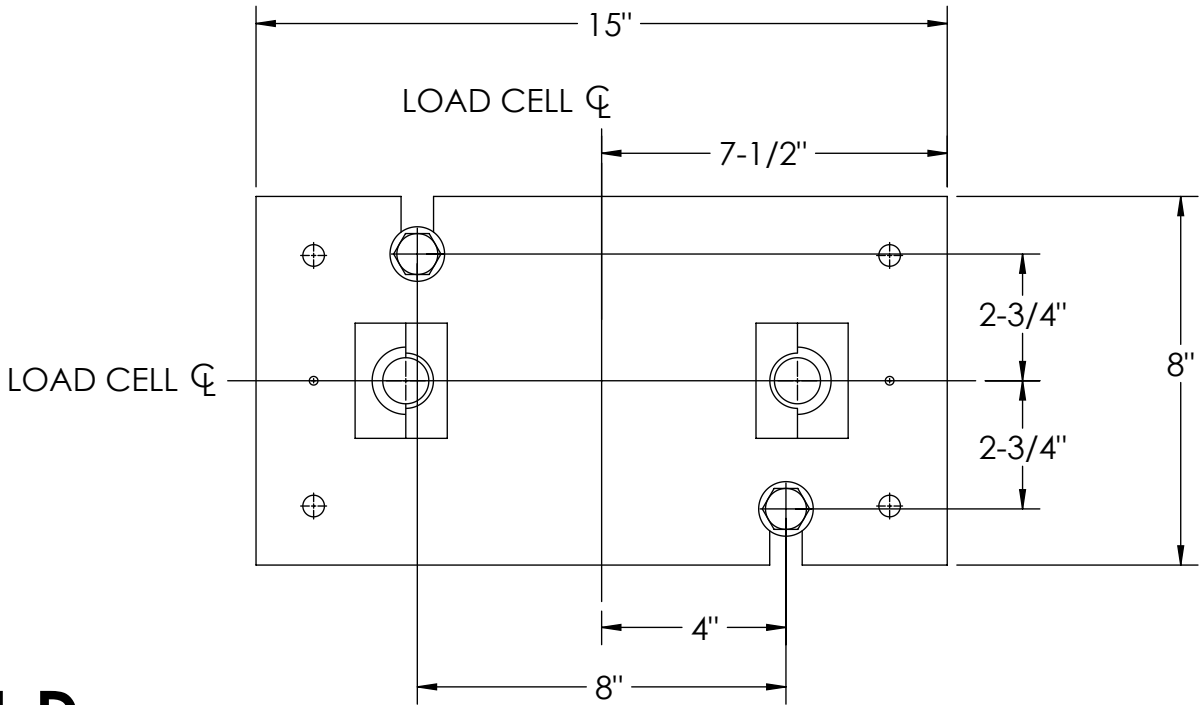

DESIGNED BY: J. JOHNSON 12/28/2020	DRAWN BY: J. JOHNSON 12/28/2020	PIER APPROVAL: J. JOHNSON 12/28/2020	RICE LAKE WEIGHING SYSTEMS	
TREATMENT NONE	THIS DRAWING AND INFORMATION CONTAINED HEREIN IS AND REMAINS THE PROPERTY OF RICE LAKE WEIGHING SYSTEMS INC. - HEREINAFTER REFERRED TO AS RLWS. IT MAY BE USED ONLY FOR RLWS' PROPOSAL AND/OR ITS CUSTOMER'S ORDERS. IT SHALL NOT BE DISCLOSED OR COPIED WITHOUT RLWS' SPECIFIC WRITTEN CONSENT AND SHALL BE IMMEDIATELY RETURNED UPON REQUEST.	UNLESS OTHERWISE SPECIFIED UNITS TO BE INCHES ALL THREADS TO BE CLASS 2 ALL DIMENSIONS APPLICABLE AFTER TREATMENT	DESCRIPTION: FOUNDATION, CONCRETE PIER 70' X 11' LOPRO OTR SERIES TRUCK SCALE	
NUMBER OF CRANES: MINIMUM CRANE CAPACITY: ESTIMATED WEIGHT (POUNDS):	DO NOT SCALE DRAWING SURFACE FINISH ✓ TOLERANCES DRAWINGS TOLERANCES UNLESS OTHERWISE SPECIFIED .XX: .XXX: ANGLE:	SCALE 1:60 SHEET 2 OF 3 MATERIAL THIRD ANGLE PROJECTION P/N 204214 REV A		

MATERIAL REQUIREMENTS				
REBAR SCHEDULE				
BAL. NO.	QUANTITY	LENGTH (FT.-IN.)	DESCRIPTION	WEIGHT
A	22	9' 6"	# 4 @ 12 O.C.	140
B	20	10' 10"	# 4 @ 12 O.C.	145
C	22	1' 5"	# 4 @ 12 O.C.	21
D	22	4' 0"	# 4 @ 12 O.C.	59
E	24	10' 10"	# 4 @ 4 O.C.	174
F	22	2' 6"	# 4 @ 12 O.C.	37
G	16	10' 10"	# 4 @ 4 O.C.	116
CLEANOUT SCHEDULE				
H	6	17' 10 1/2"	# 4 @ 24 O.C.	72
J	29	10' 10"	# 4 @ 24 O.C.	210
K	12	19' 10"	# 4 @ 24 O.C.	159
TOTAL WEIGHT OF REBAR (LBS.)				1131
TOTAL LENGTH OF REBAR (FT.)				1693
WIRE MESH		6 X 6-10 GA.		0 SQ.FT

REBAR LAYOUT

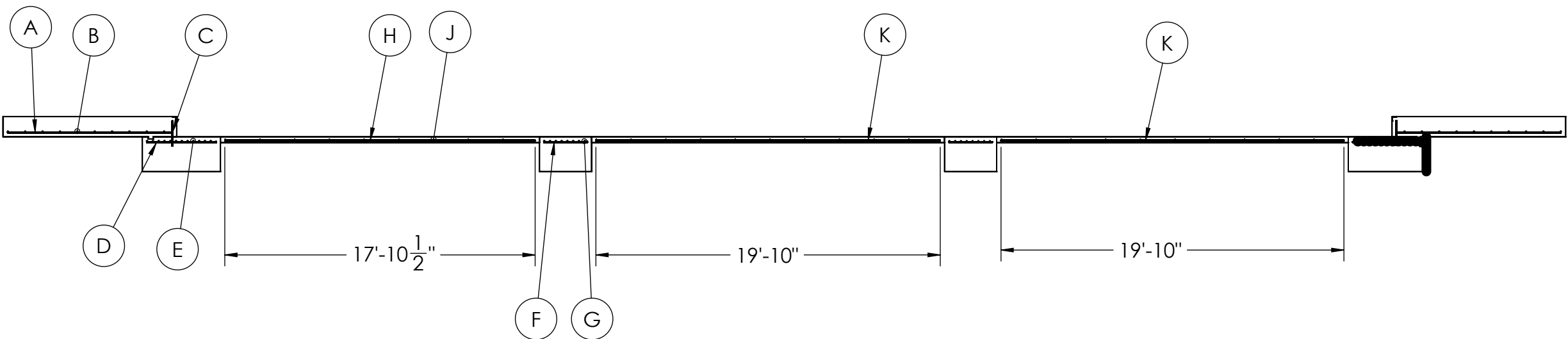

#4 REBAR SPACED EVERY 24"
OR YOU MAY SUBSTITUTE
6X6X10 GA. WIRE MESH

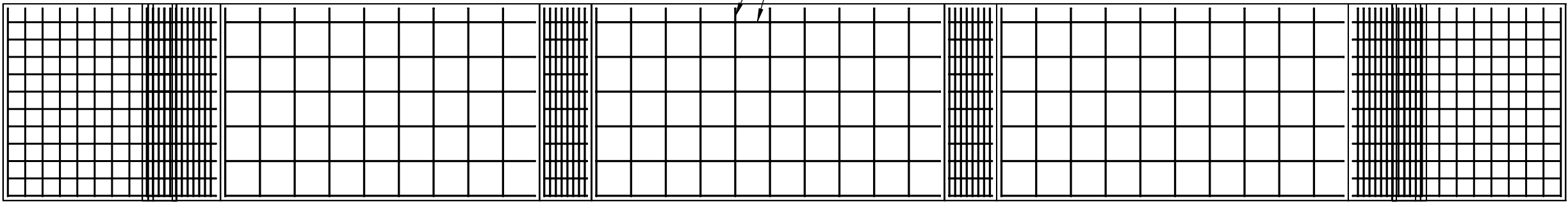

APPROACH STANDARD VIEWS

NOTES: 1) LEFT AND RIGHT APPROACHES ARE MIRROR IMAGES OF EACH OTHER AND CONTAIN AN IDENTICAL PART LIST

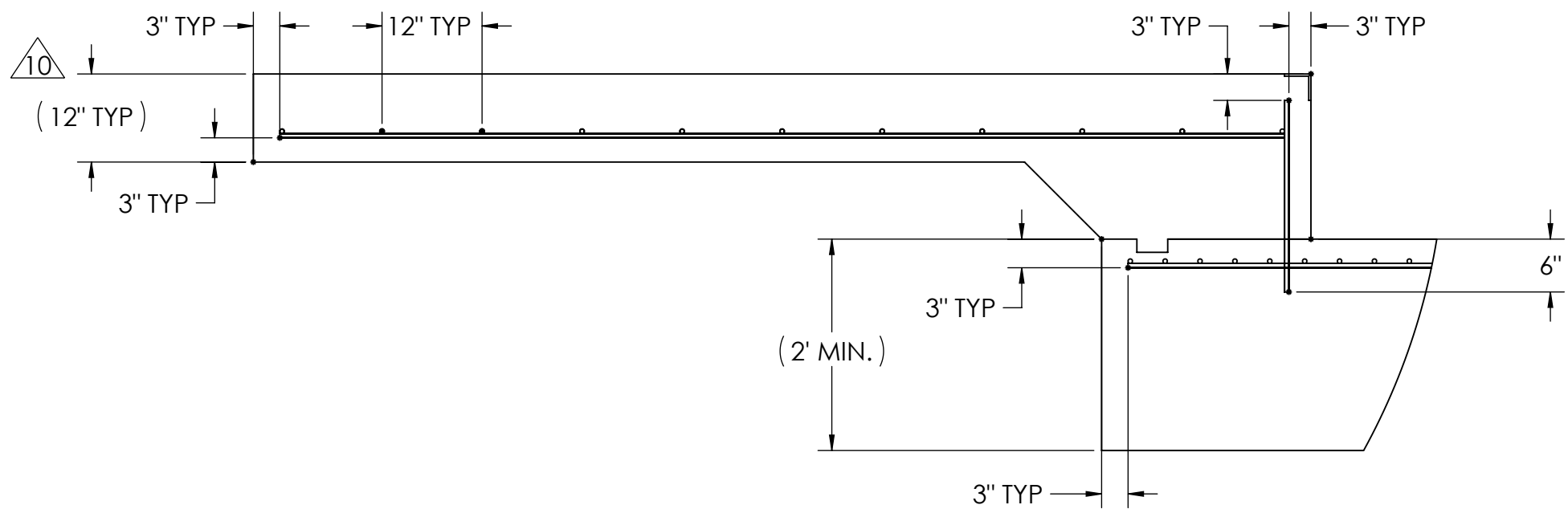

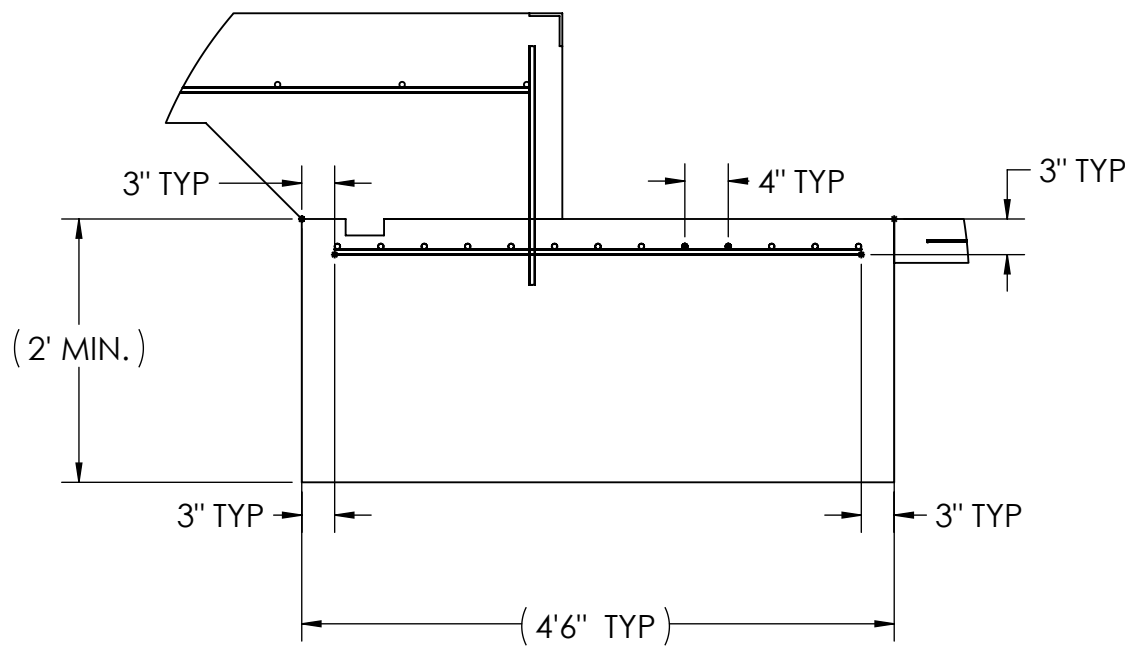

APPROACH PIER STANDARD VIEWS

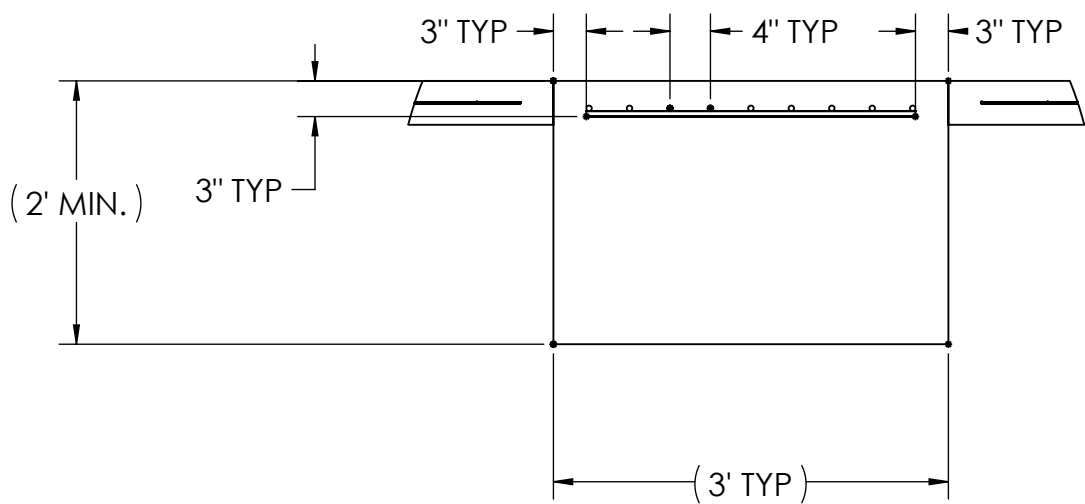

PIER STANDARD VIEWS



DESIGNED BY DATE S. JOHNSON 12/28/2020		DRAWN BY DATE S. JOHNSON 12/28/2020		FIELD OFFICIAL DATE S. JOHNSON 12/28/2020			
TREATMENT NONE		THIS DRAWING AND INFORMATION CONTAINED HEREIN IS AND REMAINS THE PROPERTY OF RICE LAKE WEIGHING SYSTEMS INC. HEREINAFTER REFERRED TO AS RICE LAKE. IT MAY BE USED FOR THE "RUM" PROPOSAL AND/OR ITS CUSTOMER'S PURPOSES. IT SHALL NOT BE REPRODUCED OR COPIED WITHOUT RICE LAKE'S WRITTEN CONSENT AND SHALL BE IMMEDIATELY RETURNED UPON REQUEST.		UNLESS OTHERWISE SPECIFIED UNITS TO BE IN INCHES ALL THREADS TO BE CLASS 2 ALL DIMENSIONS APPLICABLE AFTER TREATMENT			
NUMBER OF CRANES MINIMUM CRANE CAPACITY (ESTIMATED WEIGHT POINT(S))		 DO NOT SCALE DRAWING SURFACE FINISH ✓ ANGLE: ±		TOLERANCES DRAWING TOLERANCES UNLESS OTHERWISE SPECIFIED .XX; ± .XXX; ± ANGLE: ±		DESCRIPTION FOUNDATION, CONCRETE PIER 70" x 11" LOPRO OTR SERIES TRUCK SCALE	
				SCALE 1:48		SHEET 3 OF 3	
				THIRD ANGLE PROJECTION 		P/N 204214	
						REV A	